

# Getting Started with CrisisGo Safe2Speakup

---

CSD Health Screening - App for Secondary Students



**Corvallis**  
SCHOOL DISTRICT

# Download free CrisisGo Safe2Speakup App

[iTunes/App Store](#)

[Google Play/Android Store](#)

Safe2Speakup is the student version of the CrisisGo App



Open Safe2Speakup App

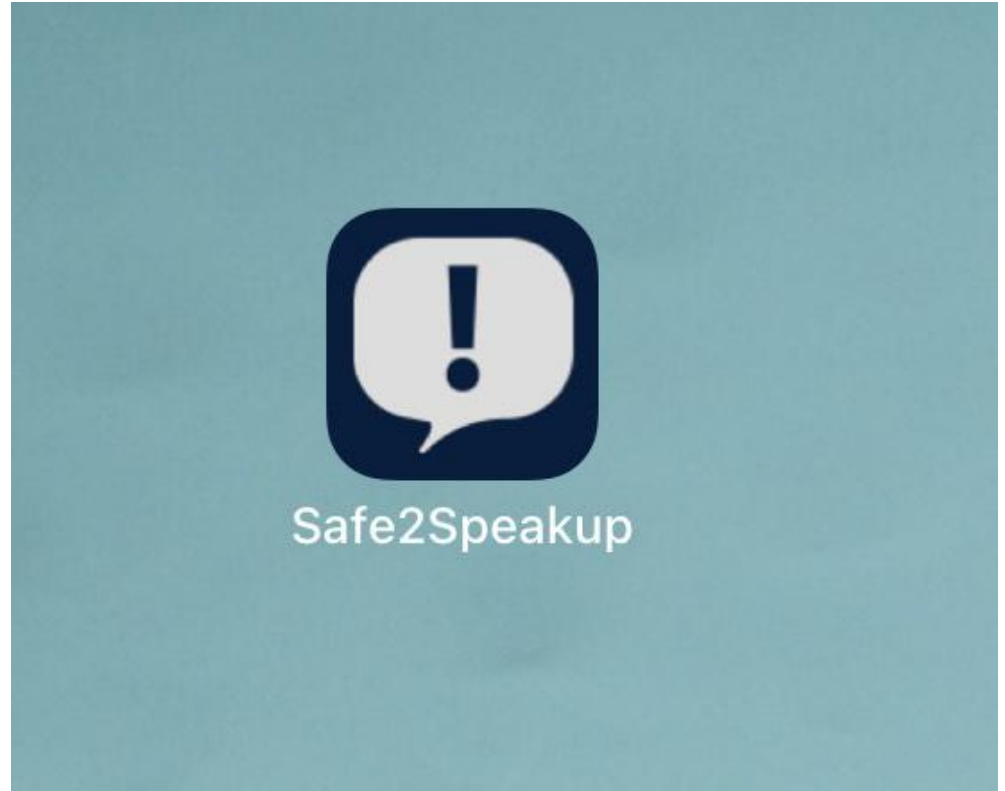

# Sign In with SSO

## Use your school district email

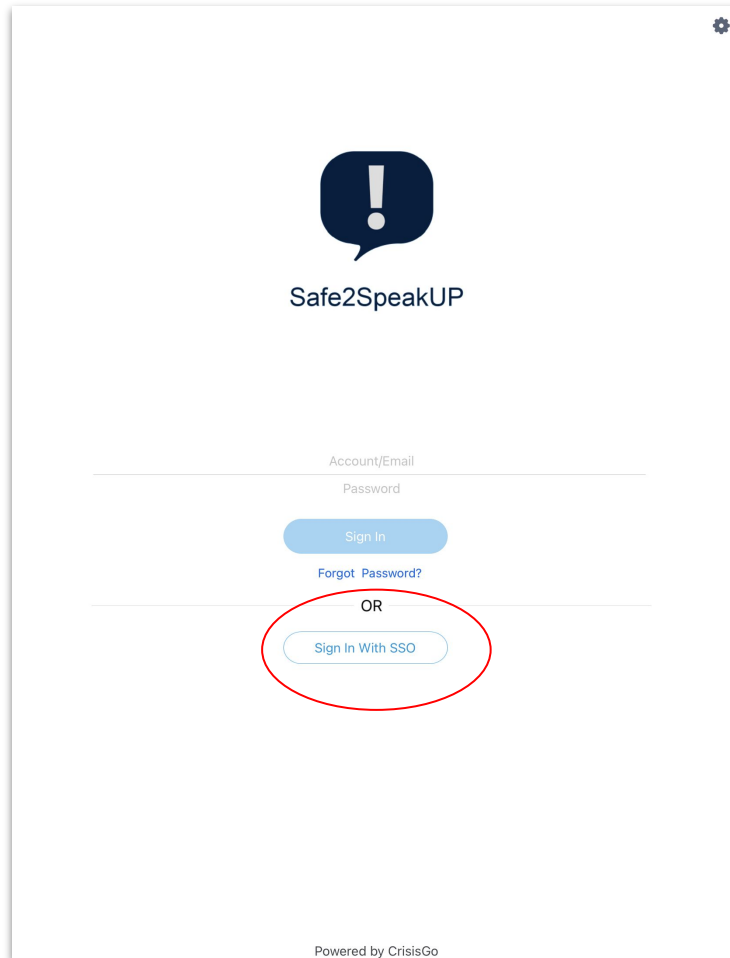

The image shows a login interface for Safe2SpeakUP. At the top center is a dark blue speech bubble icon containing a white exclamation mark, with the text "Safe2SpeakUP" below it. In the top right corner, there is a small gear icon. Below the logo, there are two input fields: "Account/Email" and "Password". A blue "Sign In" button is positioned below the "Password" field. Below the button is a link that says "Forgot Password?". A horizontal line separates this section from the SSO section. Below the line, the text "OR" is centered. Underneath "OR" is a light blue button with the text "Sign In With SSO", which is circled in red. At the bottom of the page, it says "Powered by CrisisGo".

Account/Email

Password

Sign In

[Forgot Password?](#)

OR

Sign In With SSO

Powered by CrisisGo

Type Google Email Address-- first.last@student.csd509j.net

CRISIS GO

Sign in with your Single Sign-On credentials

Enter your organizational email

Continue

# Authenticate with Google

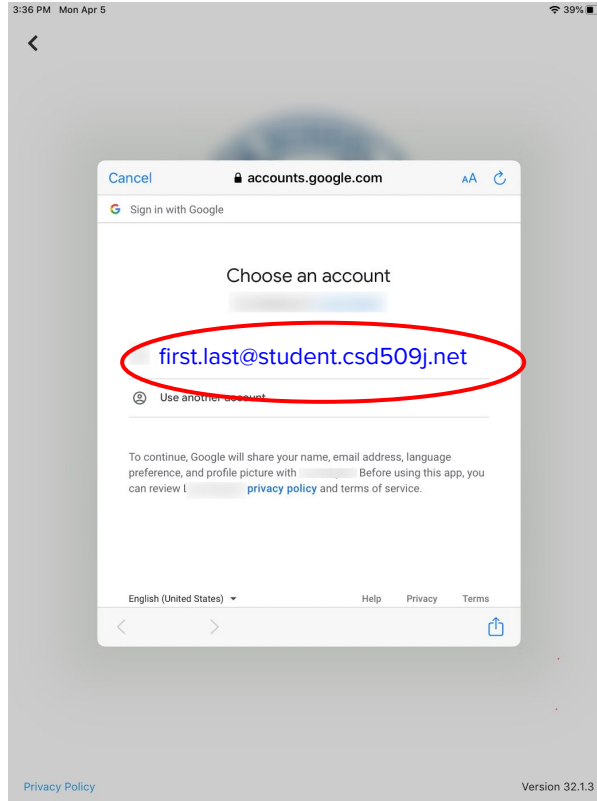

# Open this page in “CrisisGo”

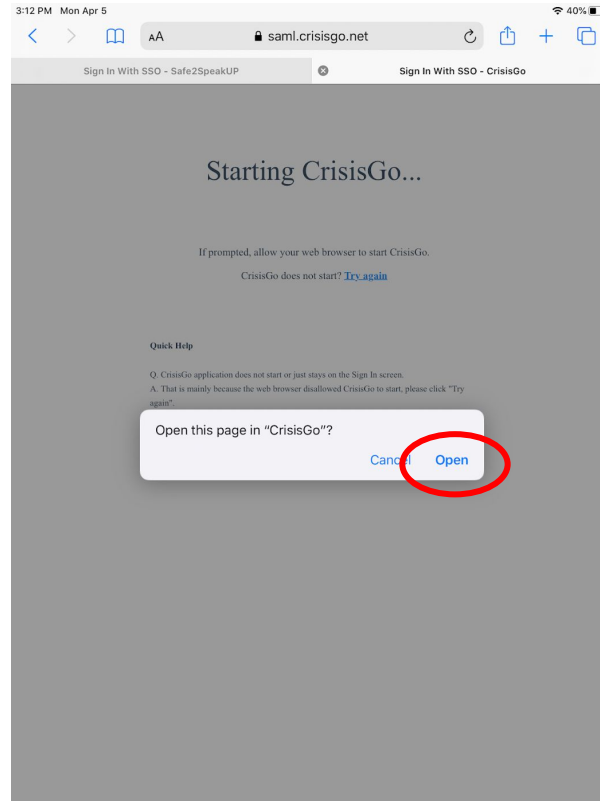

Select iPass to  
answer Health  
Screening questions

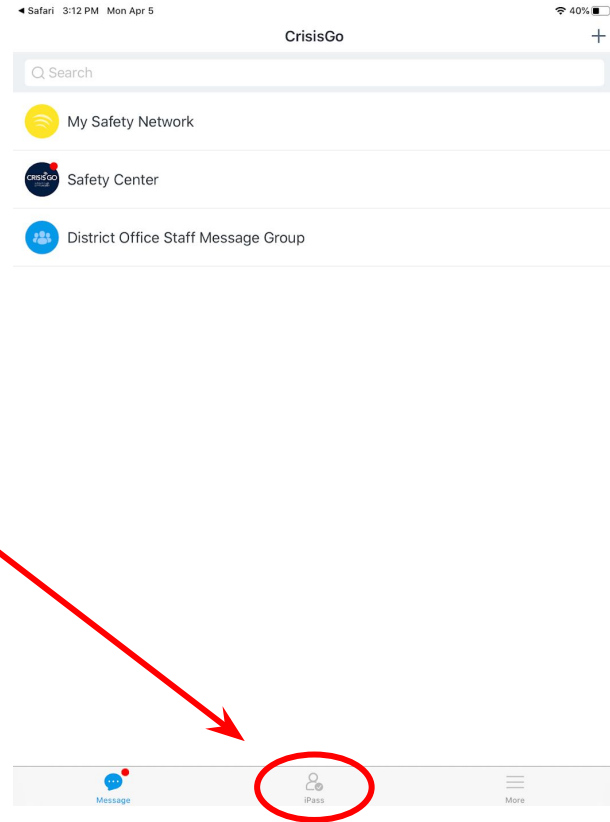



# Report Pre-Visit Self-Certification (Health Screening)

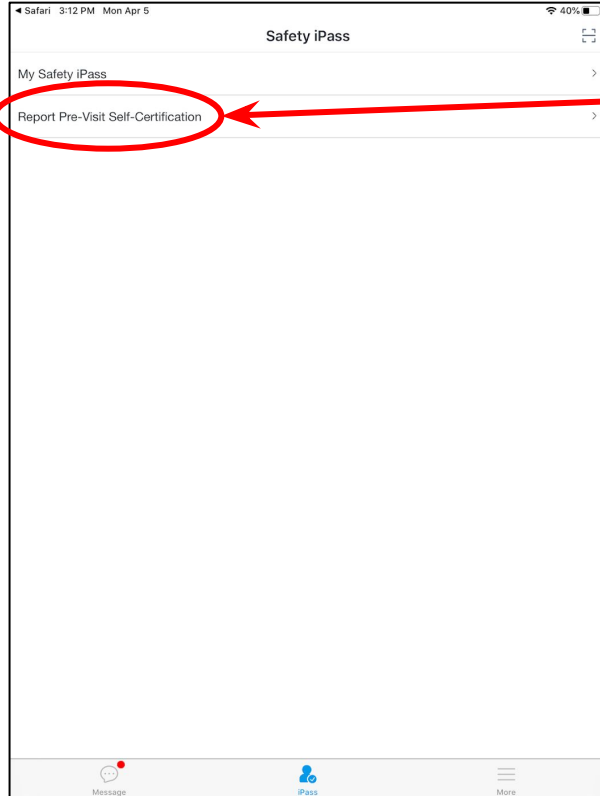

A screenshot of the "Report Pre-Visit Self-Certification" form. The title bar reads "Report Pre-Visit Self-Certification". Below the title bar, there is a blue header with the text "Staff Pre-Visit Self-Certification" and "District Office". A language dropdown menu is set to "English". The form contains the following sections:

**COVID-19 Health Screening**

Please review the Primary Symptoms:

- \* Cough
- \* Temperature of 100.4° F or greater
- \* Chills
- \* Shortness of breath
- \* Difficulty breathing
- \* New loss of taste or smell

Please review the Other Symptoms:

- \* Fatigue
- \* Muscle or body aches
- \* Headache
- \* Sore throat
- \* Nasal congestion or runny nose
- \* Nausea or vomiting
- \* Diarrhea

Please review all questions below.

- \* Have one or more Primary symptoms?
- \* Have two or more Other symptoms?
- \* No symptoms, but have a positive COVID-19 test?
- \* No symptoms, but have had close contact with someone (within 6 feet for a cumulative of 15 minutes or more, over a 24 hour period) with a confirmed or presumptive case of COVID-19?\*

At the bottom, there are two radio button options: "Yes" and "No".

# My Safety iPass Displays Your Digital Entry Badge (after completing the Health Screener)

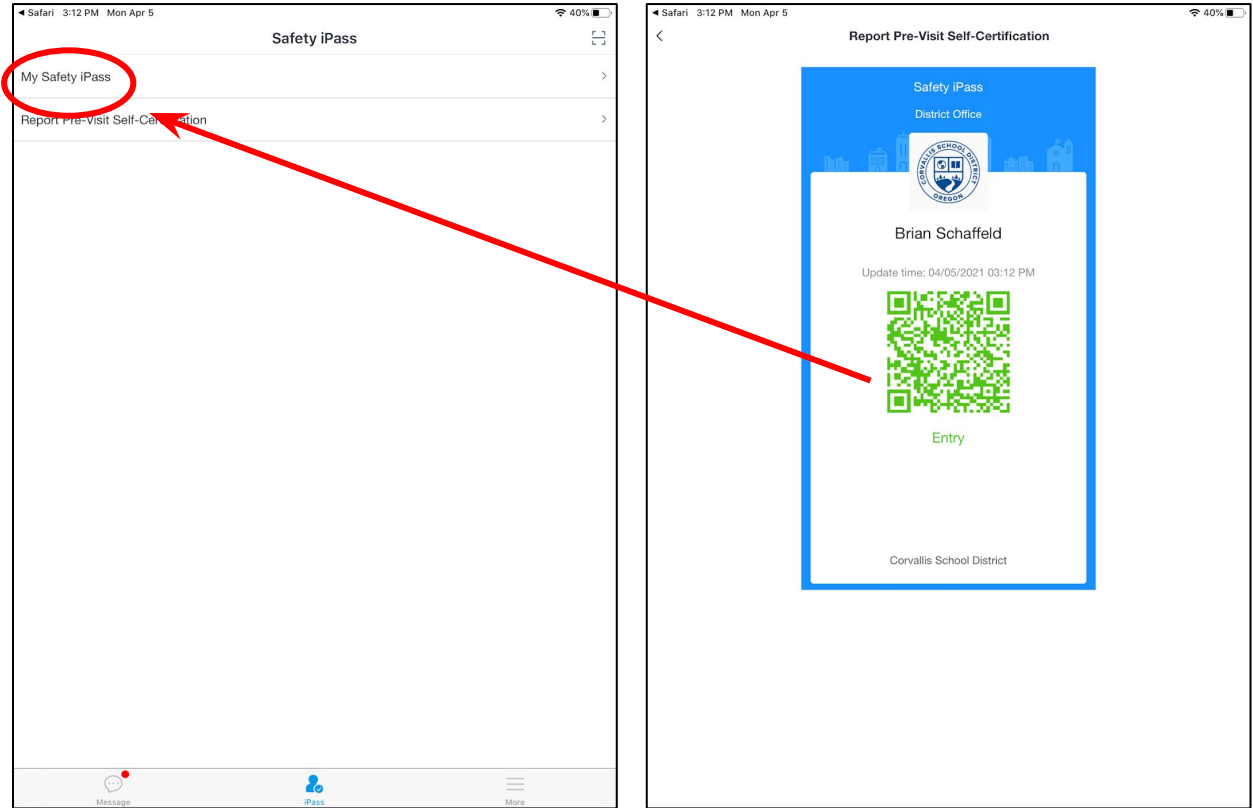

The Corvallis School District does not discriminate on the basis of age, citizenship, color, disability, gender expression, gender identity, national origin, parental or marital status, race, religion, sex, or sexual orientation in its programs and activities, and provides equal access to designated youth groups. The following person has been designated to handle inquiries regarding discrimination: **Jennifer Duvall**, Human Resources Director and Title IX Coordinator, [jennifer.duvall@corvallis.k12.or.us](mailto:jennifer.duvall@corvallis.k12.or.us) 541-757-5840 | 1555 SW 35<sup>th</sup> Street, Corvallis, OR 97333