

TOTAL ADDITION SQF:  
TOTAL RENOVATION SQF:

CAPACITY:  
BUDGET:

## BIG IDEA: New Elementary School

This requires:

- Minimum 10 acre site
- Building to house (3) sections equating to 25 teaching spaces of general education and specialty classrooms, support spaces, gymnasium and separate cafeteria
- Separated parking, bus, and parent drop-off
- 3,000 SF play shelter
- Play field large enough to hold U12 soccer field and 2 backstops

MIN 10 Acre Site - TBD

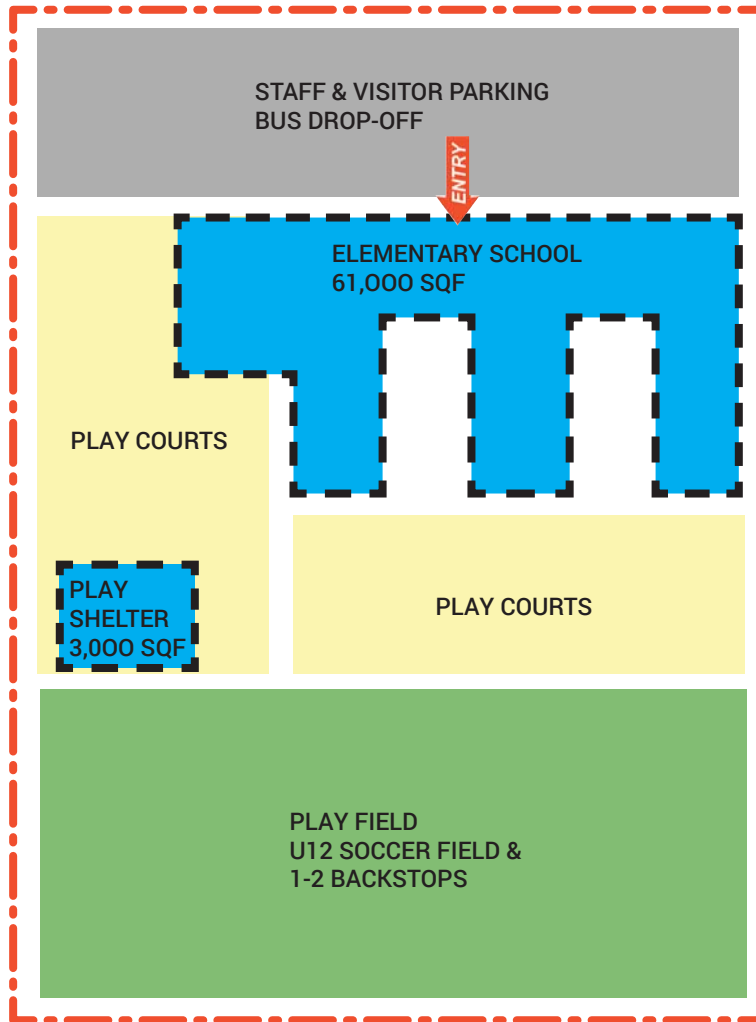





NOT TO SCALE  
GRAPHIC ONLY



TOTAL ADDITION SQF:  
TOTAL RENOVATION SQF:

CAPACITY:  
BUDGET:

LEGEND

-  NEW CONSTRUCTION
-  RECONFIGURE
-  LIGHT REFRESH
-  EXISTING / UNALTERED

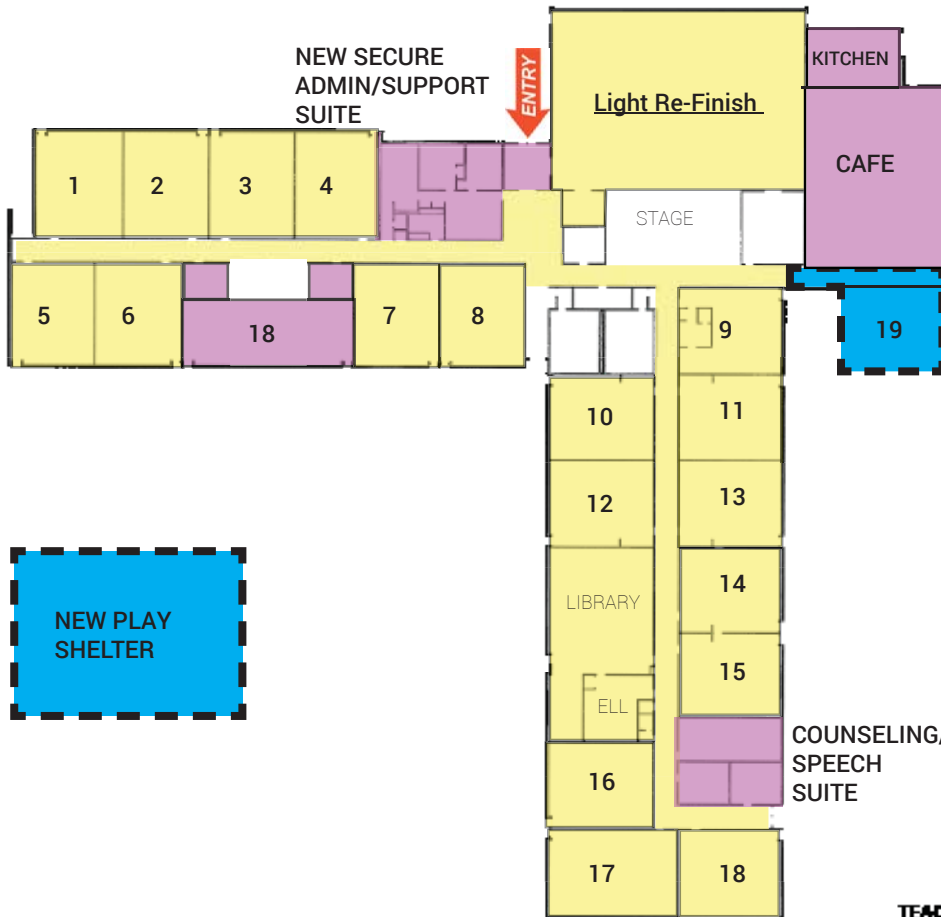

**BIG IDEA:** Adams ES to accommodate (2) sections, create separate gym/cafeteria facilities, eliminate all portables, create collaboration spaces, & interior refresh throughout.

This requires:

- Reconfigure classrooms for optimal placement/adjacencies
- Reconfigure (2) adjacent classrooms to accommodate shared pull-out/small group areas
- Reconfigure main office for controlled entry vestibule
- Reconfigure storage/locker area and expand to create cafeteria, re-orient kitchen
- Extend existing hallway toward new cafeteria, add one classroom
- Provide new covered play shelter
- Remodel existing ELL/Title I spaces

TEACHING STATION	QTY	Target Loading	Capacity
<b>Learning Suite</b>			
Kindergarten Classroom	2	24	46
First Grade Classroom	2	26	49
Second Grade Classroom	2	26	49
Third Grade Classroom	2	27	51
Fourth Grade Classroom	2	31	59
Fifth Grade Classroom	2	31	59
Grade Flexible Classroom	1	26	25
Collaborative Commons	2	up to 60	—
Small Group Gathering	2	6-8	—
<b>Specialized Learning Spaces</b>			
Music	1	31	—
Art/Science Lab	1	31	—
<b>Special Education</b>			
Early Learning	1	20	20
Learning Resource Center	1	20	—
Sp.Ed. Classroom	1	8	8
<b>Media Center</b>			
Computer lab/Testing	1	31	—
<b>Total Teaching Stations (Classrooms)</b>			<b>19</b>
<b>Capacity Total</b>			<b>338</b>

\*Capacity Generating Rooms



TOTAL ADDITION SQF:  
TOTAL RENOVATION SQF:

CAPACITY:  
BUDGET:

## LEGEND

- NEW CONSTRUCTION
- RECONFIGURE
- LIGHT REFRESH
- EXISTING / UNALTERED

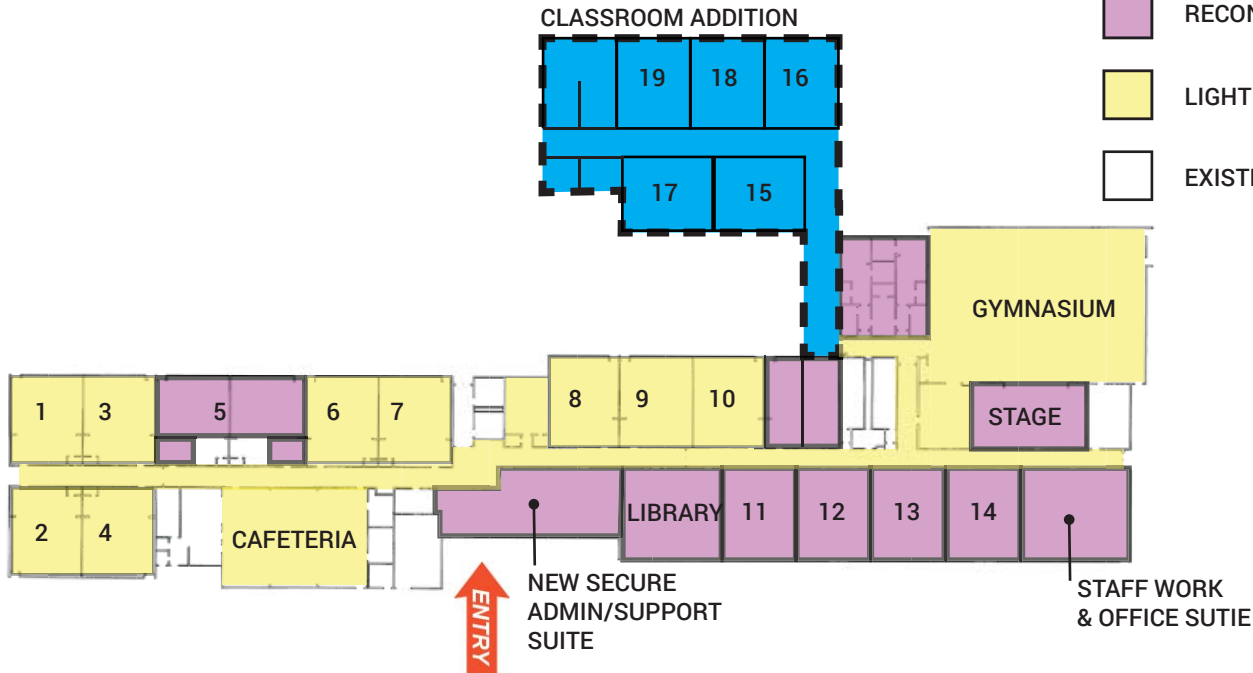

**BIG IDEA: Garfield ES to accommodate (2) sections, eliminate portables, provide collaboration spaces**

This requires:

- Add new (5) classroom wing, connect to main building through existing classroom space reconfigured to hallway and pull-out space
- Reconfigure front, east wing to provide for secure entry with expanded admin, new staff lounge/work/office suite, increased LRC/specialist/SPED. suite, and library/computer lab
- Reconfigure (2) adjacent classrooms to accommodate shared pull-out/small group areas
- Reconfigure lockers for appropriate storage space
- Recapture stage area for performance use
- Light renovation to main hallway for light and display

TEACHING STATION	QTY	Target Loading	Capacity
<b>Learning Suite</b>			
Kindergarten Classroom	2	24	46
First Grade Classroom	2	26	49
Second Grade Classroom	2	26	49
Third Grade Classroom	2	27	51
Fourth Grade Classroom	2	31	59
Fifth Grade Classroom	2	31	59
Grade Flexible Classroom	1	26	25
Collaborative Commons	2	up to 60	—
Small Group Gathering	2	6-8	—
<b>Specialized Learning Spaces</b>			
Music	1	31	—
Art/Science Lab	1	31	—
<b>Special Education</b>			
Early Learning	1	20	20
Learning Resource Center	1	20	—
Sp.Ed. Classroom	1	8	8
<b>Media Center</b>			
Computer lab/Testing	1	31	—
<b>Total Teaching Stations (Classrooms)</b>			19
<b>Capacity Total</b>			338



\*Capacity Generating Rooms



TOTAL ADDITION SQF:  
TOTAL RENOVATION SQF:

CAPACITY:  
BUDGET:

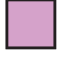
LEGEND

-  NEW CONSTRUCTION
-  RECONFIGURE
-  LIGHT REFRESH
-  EXISTING / UNALTERED

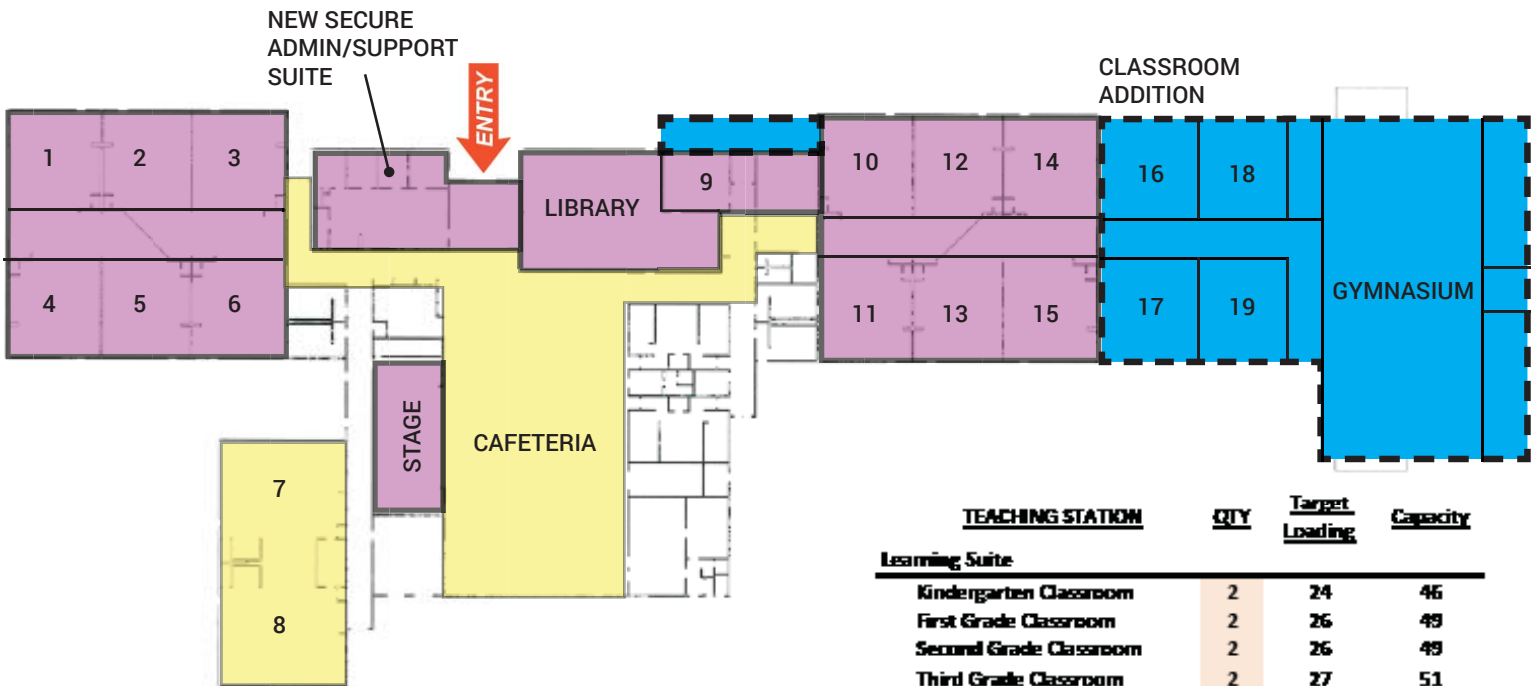

**BIG IDEA: Hoover to accommodate (2) sections eliminate portable classrooms, provide separate gym facilities, reconfigure interior corridors**

This requires:

- Reconfigure existing classroom wings to double-loaded corridors
- Recapture stage area for performance use
- Reconfigure library to expand Sp.Ed. facilities
- Expand admin area to secure front entry
- Expand school by adding (4) classrooms and a gymnasium with support functions at east end of school

TEACHING STATION	QTY	Target Loading	Capacity
<b>Learning Suite</b>			
Kindergarten Classroom	2	24	46
First Grade Classroom	2	26	49
Second Grade Classroom	2	26	49
Third Grade Classroom	2	27	51
Fourth Grade Classroom	2	31	59
Fifth Grade Classroom	2	31	59
Grade Flexible Classroom	1	26	25
Collaborative Commons	2	up to 60	—
Small Group Gathering	2	6-8	—
<b>Specialized Learning Spaces</b>			
Music	1	31	—
Art/Science Lab	1	31	—
<b>Special Education</b>			
Early Learning	1	20	20
Learning Resource Center	1	20	—
Sp.Ed. Classroom	1	8	8
<b>Media Center</b>			
Computer lab/Testing	1	31	—
<b>Total Teaching Stations (Classrooms)</b>			<b>19</b>
<b>Capacity Total</b>			<b>338</b>





\*Capacity Generating Rooms



TOTAL ADDITION SQF:  
TOTAL RENOVATION SQF:

CAPACITY:  
BUDGET:

LEGEND

-  NEW CONSTRUCTION
-  RECONFIGURE
-  LIGHT REFRESH
-  EXISTING / UNALTERED

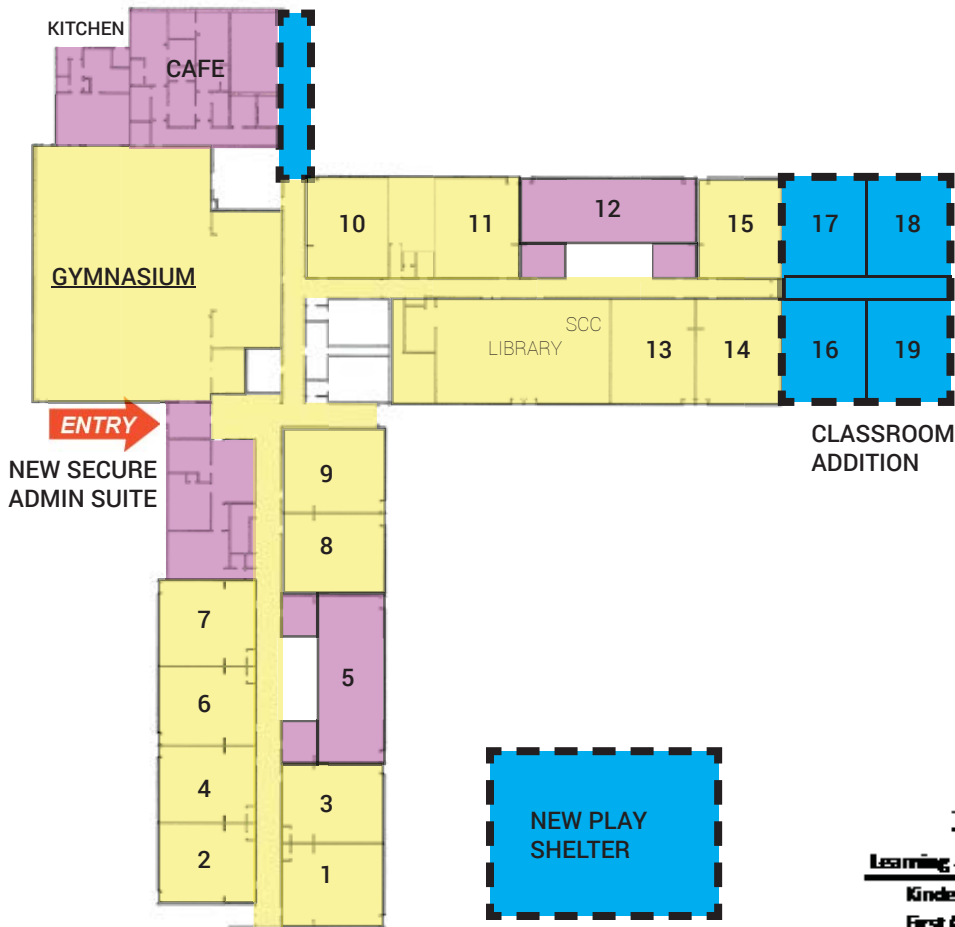

**BIG IDEA: Jefferson ES to accommodate (2) sections, eliminate use of portable classrooms, provide separate gymnasium and cafeteria spaces, and refreshing interiors throughout**

This requires:

- Reconfigure storage locker room to the north to house expanded cafeteria
- Add (4) classrooms extension to the east classroom wing
- Reconfigure (2) adjacent classrooms to create pull-out/ small group areas
- Redonfigure and expand the main entry to create secured entry

TEACHING STATION	QTY	Target Loading	Capacity
<b>Learning Suite</b>			
Kindergarten Classroom	2	24	46
First Grade Classroom	2	26	49
Second Grade Classroom	2	26	49
Third Grade Classroom	2	27	51
Fourth Grade Classroom	2	31	59
Fifth Grade Classroom	2	31	59
Grade Flexible Classroom	1	26	25
Collaborative Commons	2	up to 60	—
Small Group Gathering	2	6-8	—
<b>Specialized Learning Spaces</b>			
Music	1	31	—
Art/Science Lab	1	31	—
<b>Special Education</b>			
Early Learning	1	20	20
Learning Resource Center	1	20	—
Sp.Ed. Classroom	1	8	8
<b>Media Center</b>			
Computer lab/Testing	1	31	—
<b>Total Teaching Stations (Classrooms)</b>			<b>19</b>
<b>Capacity Total</b>			<b>338</b>

\*Capacity Generating Rooms



TOTAL ADDITION SQF:  
TOTAL RENOVATION SQF:

CAPACITY:  
BUDGET:



**BIG IDEA:**

Option A: Purchase land in south area and build new Lincoln ES accommodating (3) sections

Option B: Rebuild Lincoln ES on the back side of the existing site to increase safety and security

TOTAL ADDITION SQF:  
TOTAL RENOVATION SQF:

CAPACITY:  
BUDGET:

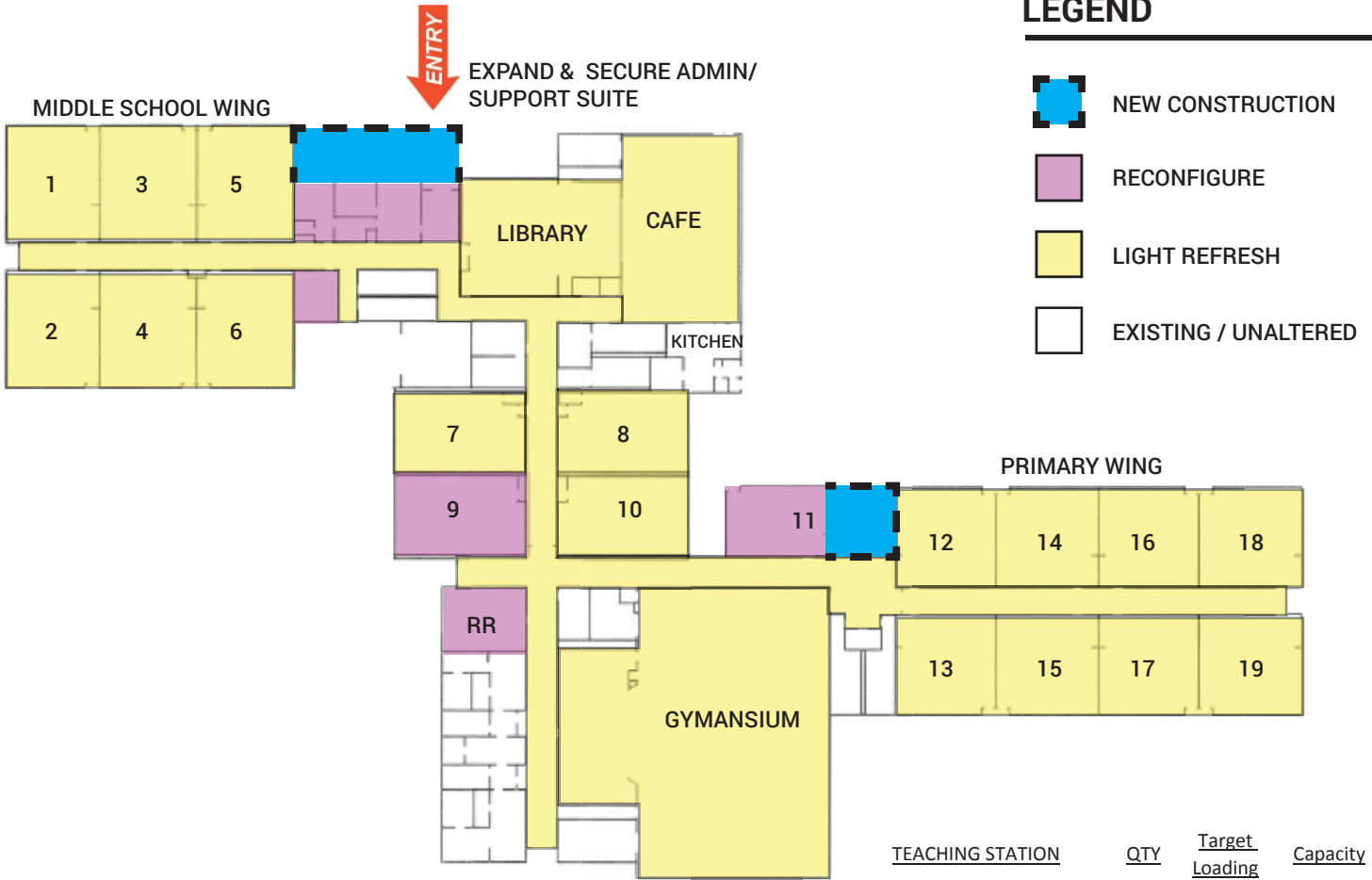

TEACHING STATION	QTY	Target Loading	Capacity
<b>Learning Suite</b>			
Kindergarten Classroom	1	24	23
First Grade Classroom	1	26	25
Second Grade Classroom	1	26	25
Third Grade Classroom	1	27	26
Fourth Grade Classroom	1	31	29
Fifth Grade Classroom	1	31	29
Sixth - Eighth	6	31	177
Grade Flexible Classroom	1	26	25
Collaborative Commons		up to 60	---
Small Group Gathering		6-8	---
<b>Specialized Learning Spaces</b>			
Music	1	31	---
Art/Science Lab	1	31	---
<b>Special Education</b>			
Early Learning	1	20	20
Learning Resource Center	1	20	---
Sp.Ed. Classroom	1	8	8
<b>Media Center</b>			
Computer lab/Testing	1	31	---
<b>Total Teaching Stations</b>			<b>19</b>
			(Classrooms)
<b>Capacity Total</b>			<b>359</b>

**BIG IDEA: Convert Mount. View to K-8 to house Franklin program.**

This requires:

- Expand main entry to house staff work/break rooms, principle's office, and create secure entry
- Reconfigure principle's existing office to small group/pull-out space,
- Recapture current staff room and reconfigure to multi-user restroom, and expanse adjacent classroom to full size
- Expand teaching space accross from gymnasium to the north to full-size classroom.
- Overall interior refresh throughout

\*Capacity Generating



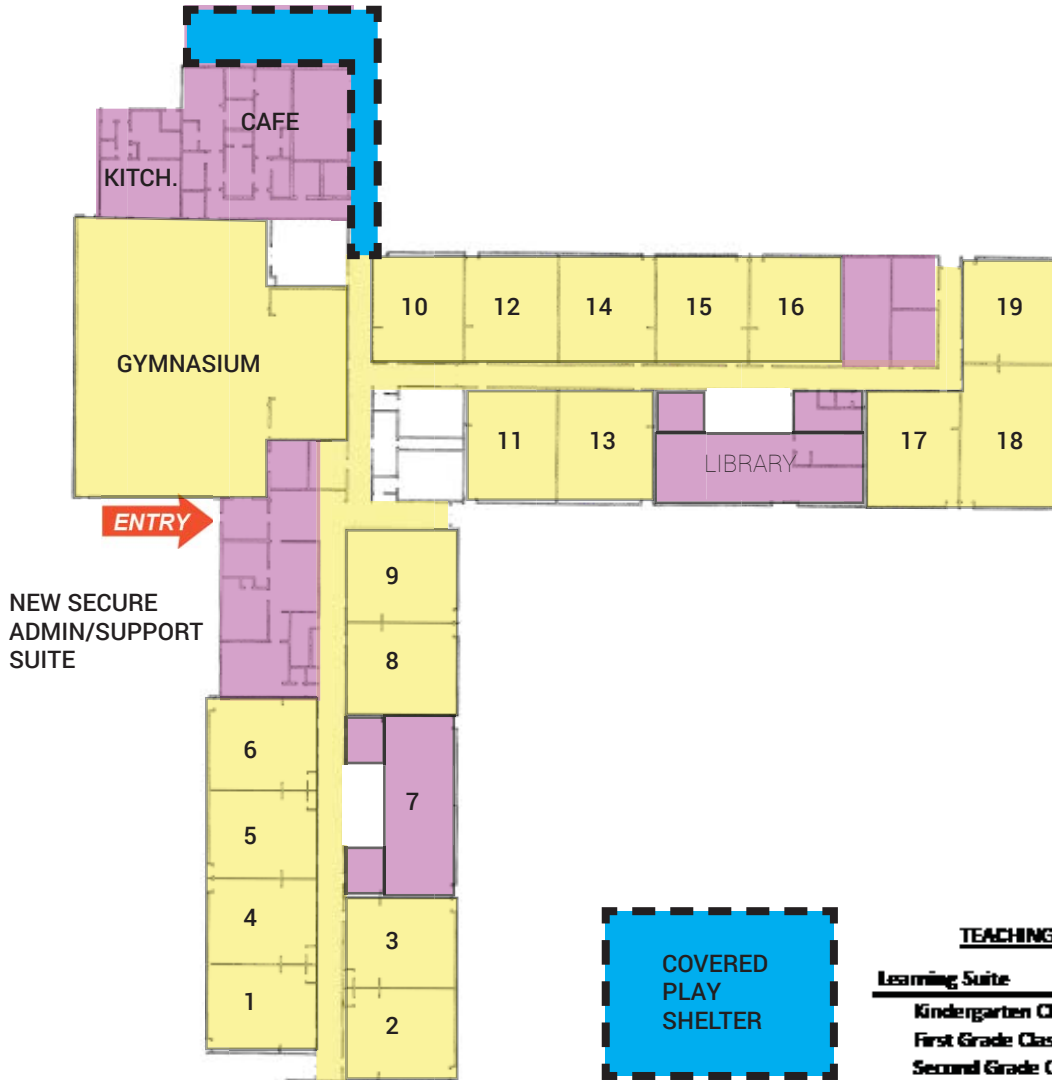

TOTAL ADDITION SQF:  
TOTAL RENOVATION SQF:

CAPACITY:  
BUDGET:

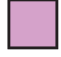

LEGEND

-  NEW CONSTRUCTION
-  RECONFIGURE
-  LIGHT REFRESH
-  EXISTING / UNALTERED

NEW SECURE  
ADMIN/SUPPORT  
SUITE

**BIG IDEA:** Wilson ES to accommodate (2) sections, create separate gym/cafeteria facilities, eliminate use of portable classrooms, create collaboration spaces, & interior refresh throughout.

This requires:

- Reconfigure classrooms for optimal placement/adjacencies
- Reconfigure library and (2) adjacent classrooms to accommodate shared pull-out/small group areas
- Reconfigure and expand main office for controlled entry vestibule and improved function
- Reconfigure storage/locker area and expand to create cafeteria, re-orient kitchen
- Provide new covered play shelter

TEACHING STATION	QTY	Target Loading	Capacity
<b>Learning Suite</b>			
Kindergarten Classroom	2	24	46
First Grade Classroom	2	26	49
Second Grade Classroom	2	26	49
Third Grade Classroom	2	27	51
Fourth Grade Classroom	2	31	59
Fifth Grade Classroom	2	31	59
Grade Flexible Classroom	1	26	25
Collaborative Commons	2	up to 60	—
Small Group Gathering	2	6-8	—
<b>Specialized Learning Spaces</b>			
Music	1	31	—
Art/Science Lab	1	31	—
<b>Special Education</b>			
Early Learning	1	20	20
Learning Resource Center	1	20	—
Sp.Ed. Classroom	1	8	8
<b>Media Center</b>			
Computer lab/Testing	1	31	—
<b>Total Teaching Stations (Classrooms)</b>			<b>19</b>
<b>Capacity Total</b>			<b>338</b>

\*Capacity Generating Rooms





TOTAL ADDITION SQF:  
TOTAL RENOVATION SQF:

CAPACITY:  
BUDGET:



**BIG IDEA:** Relocate Franklin K8 to renovated Mountain View site - Demolish existin Franklin school site to allow for expansion of Corvallis High School athletic fields

CONCESSIONS,  
RESTROOM,  
STORAGE

TOTAL ADDITION SQF:  
TOTAL RENOVATION SQF:

CAPACITY:  
BUDGET:



**BIG IDEA: Build new Mountain View ES on existing Cheldelin Middle School site.**

This requires:

- Create new two-level elementary school facility at the northern are of the Cheldeling Site.
- Provide separe bus & parent drop-off from CMS
- Provide outdoor play areas and covered play shelter
- Site to accommodate (3) sections.

TOTAL ADDITION SQF:  
TOTAL RENOVATION SQF:



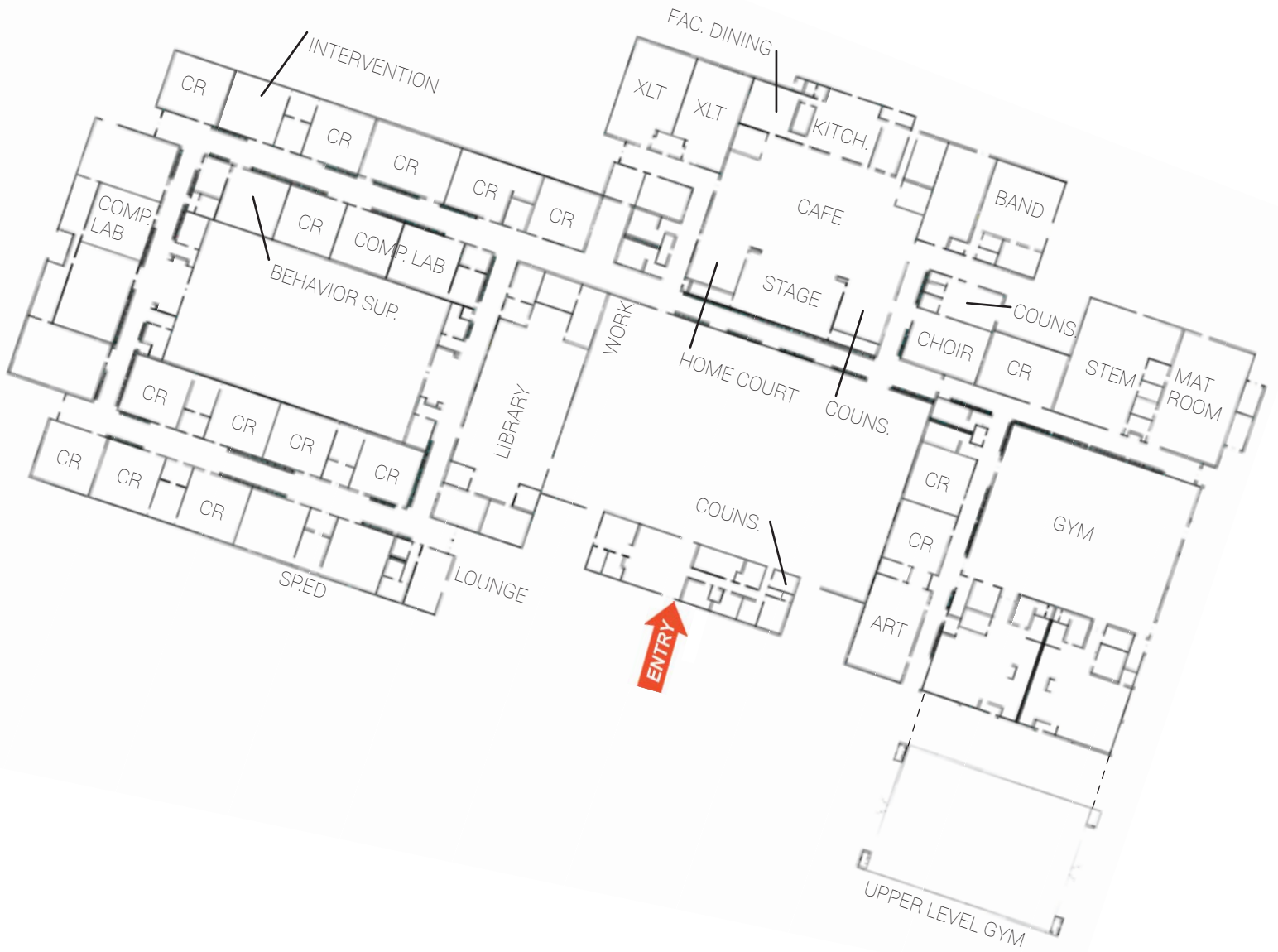

CAPACITY:  
BUDGET:



TOTAL ADDITION SQF:  
TOTAL RENOVATION SQF:

CAPACITY:  
BUDGET:

## LEGEND

-  NEW CONSTRUCTION
-  RECONFIGURE
-  LIGHT REFRESH
-  EXISTING / UNALTERED

### BIG IDEA: Create improved collaboration areas and small student commons.

This requires:

- Refresh existing common areas within pods for improved small-group & pull-out spaces
- Reconfigure central lecture hall to secondary student commons with transparency to hallways.
- Refresh art room to Applied Learning Studio
- Create covered exterior work area



FIRST LEVEL

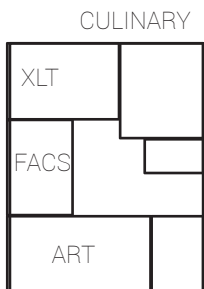

TOTAL ADDITION SQF:  
TOTAL RENOVATION SQF:

CAPACITY:  
BUDGET:

## LEGEND



NEW CONSTRUCTION



RECONFIGURE



LIGHT REFRESH



EXISTING / UNALTERED

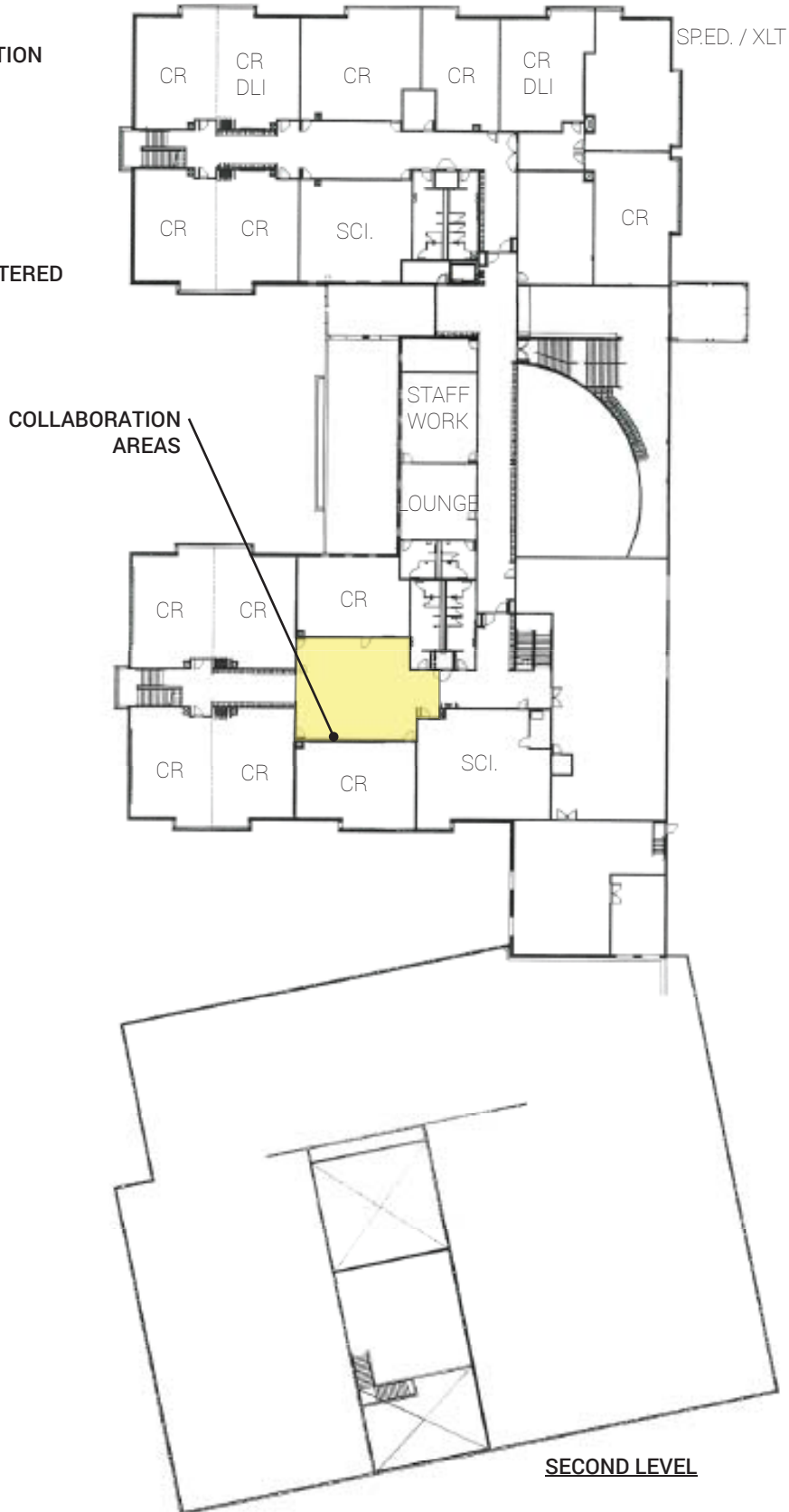

ADDRESS:  
CLASSROOMS:

MODULARS:

TOTAL PERMANENT SQF:  
YEAR BUILT:

IMPROVED SITE  
CONNECTION



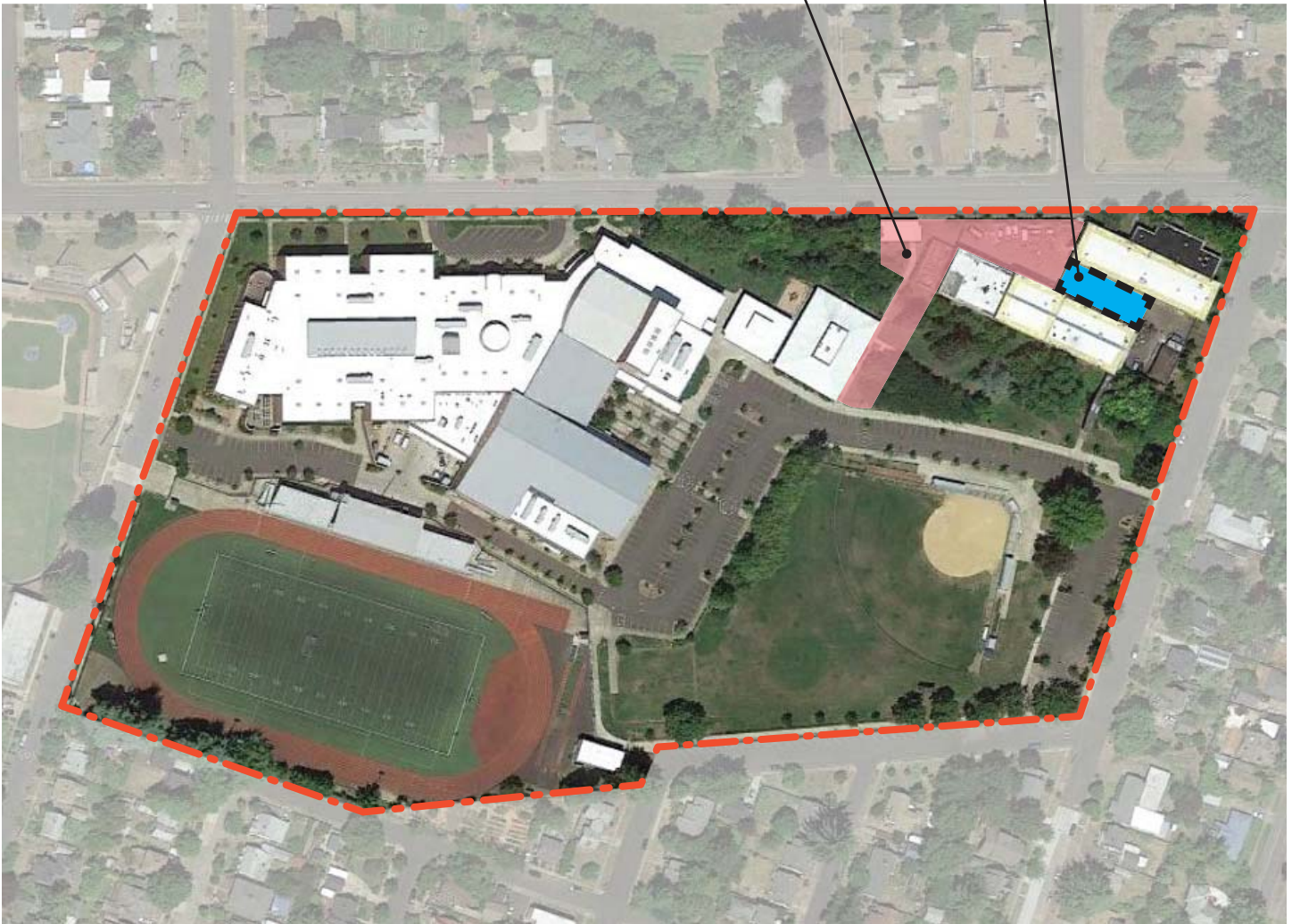

OUTDOOR COVERED  
PROJECT YARD



TOTAL ADDITION SQF:  
TOTAL RENOVATION SQF:

CAPACITY:  
BUDGET:

**LEGEND**

-  NEW CONSTRUCTION
-  RECONFIGURE
-  LIGHT REFRESH
-  EXISTING / UNALTERED

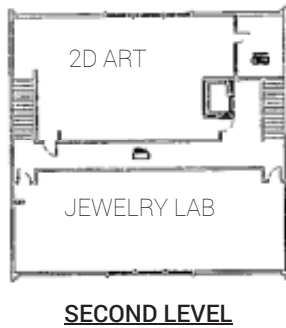
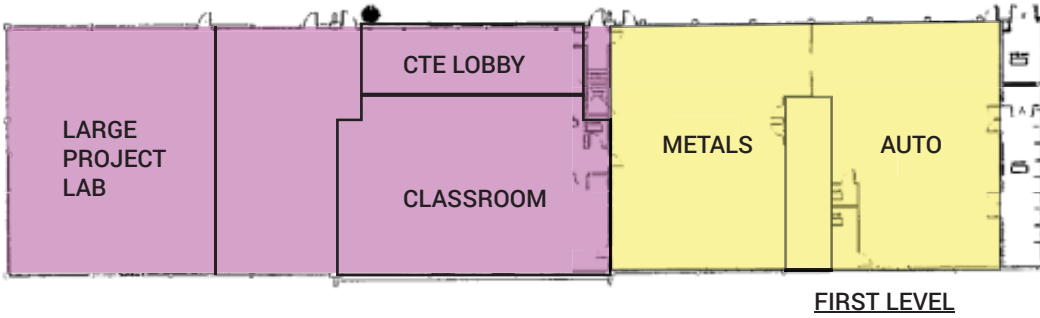
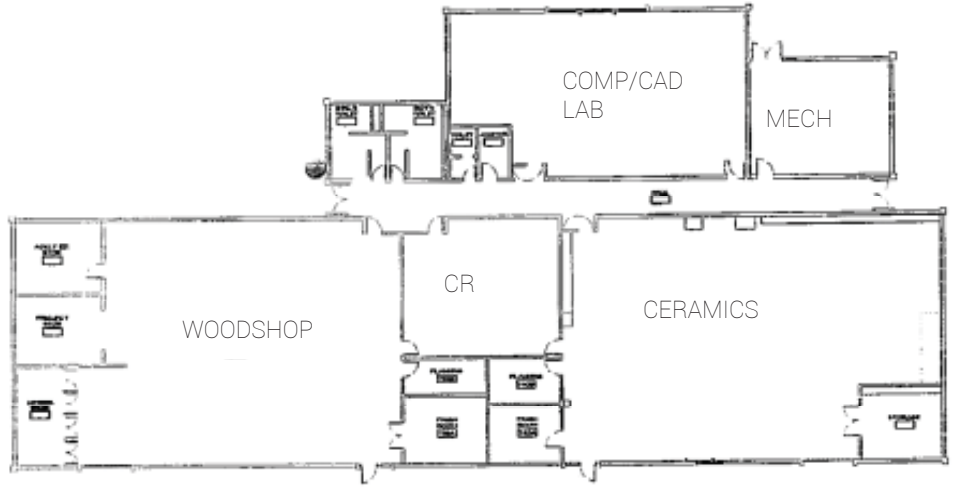

TOTAL ADDITION SQF:  
TOTAL RENOVATION SQF:

CAPACITY:  
BUDGET:

## LEGEND



NEW CONSTRUCTION



RECONFIGURE



LIGHT REFRESH



EXISTING / UNALTERED

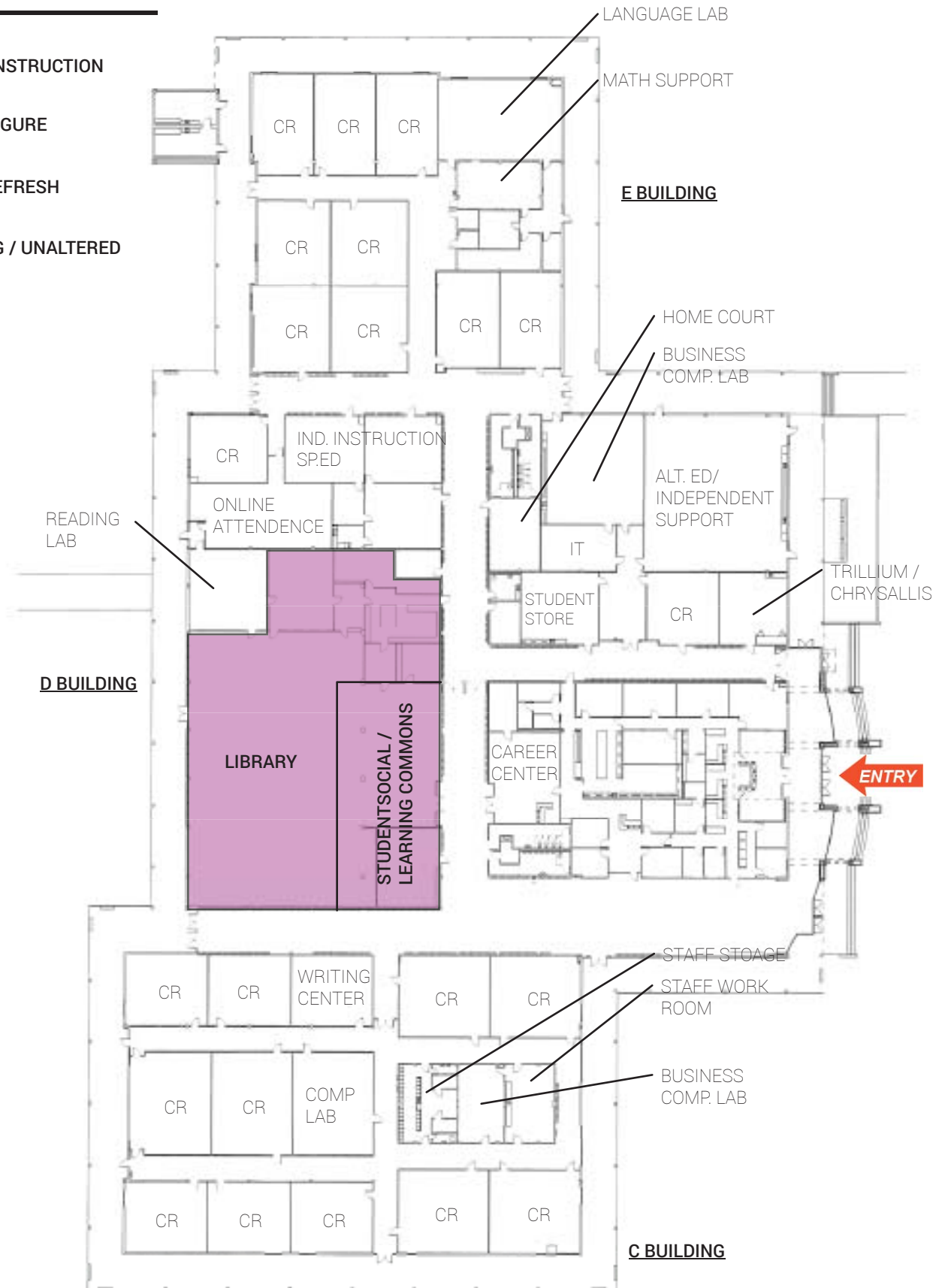



TOTAL ADDITION SQF:  
TOTAL RENOVATION SQF:



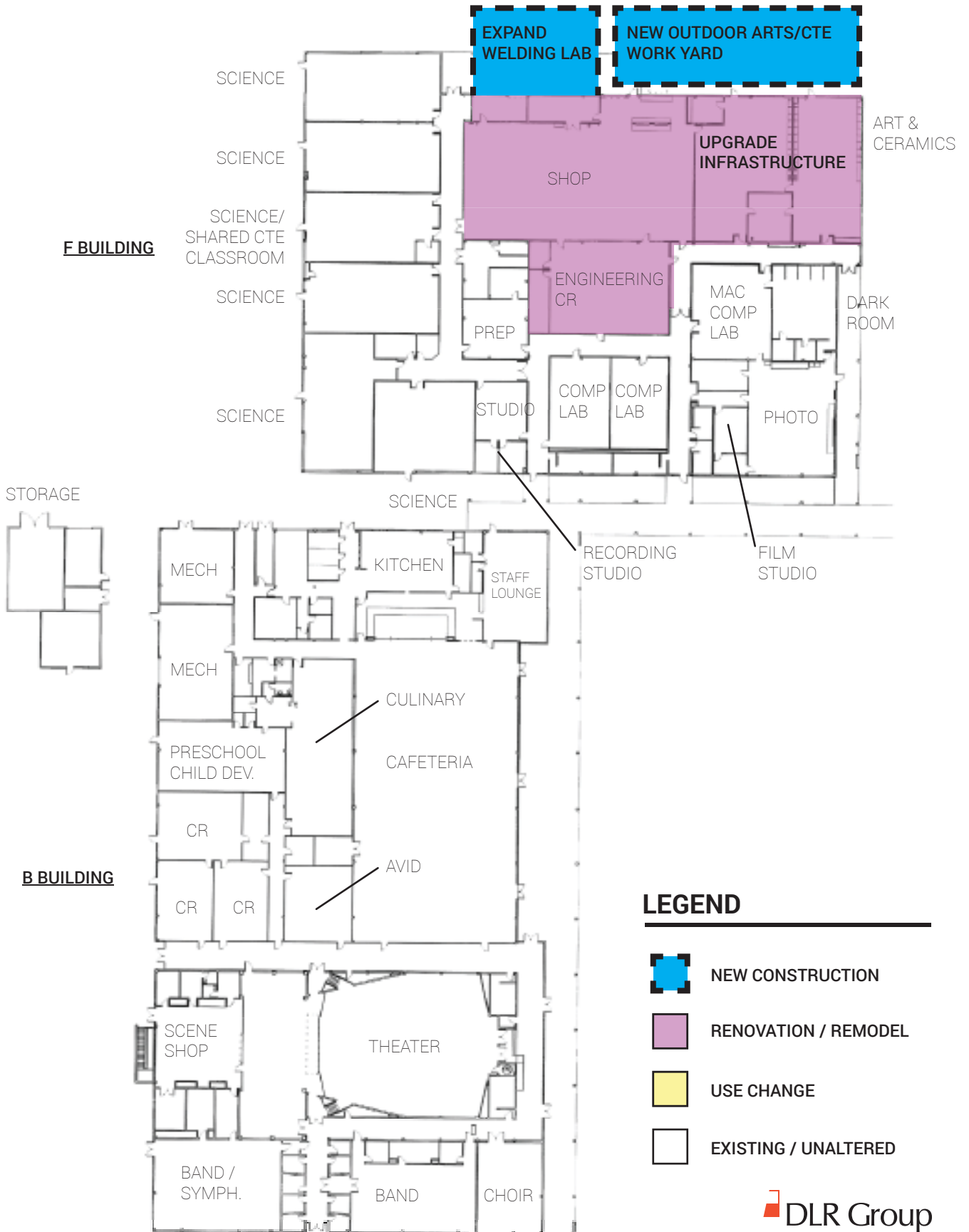

CAPACITY:  
BUDGET:



TOTAL ADDITION SQF:  
TOTAL RENOVATION SQF:

CAPACITY:  
BUDGET:

## LEGEND

-  NEW CONSTRUCTION
-  RECONFIGURE
-  LIGHT REFRESH
-  EXISTING / UNALTERED

### BIG IDEA: Renovate Harding Center to better serve the College Hill/Urban Farm program

This requires:

- Reconfigure (2) adjacent classrooms to create student/social commons
- Create new centralized cafeteria
- Reconfigure main office for controlled secure entry
- Light interior refresh throughout
- Perform all seismic upgrades to make the entire building student accessible

